

## KC CONTINUOUS MIXERS



# KC Continuous Mixers



*KCV continuous mixer in SS316 and mild steel for sludge conditioning*

*KC ploughshare continuous mixers represent the ideal solution for the user when it comes to processing large quantities of product. Available with a vertical discharge or a frontal discharge, they are perfect for intensive and heavy duty applications (24/7). Thanks to their short mixing time, top quality performance in terms of particle distribution (up to 1:100,000) and high throughput, these units provide the best solution in terms of reliability, performance and return on investment.*

*All KC mixers are available in painted mild steel, stainless steel (304 and 316) and wear-resistant steel. For special applications, different drum liners and mixing tool coatings are available on demand.*

*A wide range of accessories provides the user with the ideal mixer configuration (refiners, liquid injection systems, temperature jackets and probes, pneumatic sampling devices, special seals for fine and abrasive materials, customized inlets, main shaft cleaning rings). If and when necessary, tailor-made technical solutions can be engineered and manufactured to satisfy even the most challenging needs.*

## **KC mixers : the ultimate mixing solution**

### **Benefits**



*fast  
mixing*



*high  
throughput*



*excellent particle  
distribution*



*maximum  
saving*



*guaranteed  
scale-up*

## Tools & Accessories



*food-grade polished SS304  
welded blades*

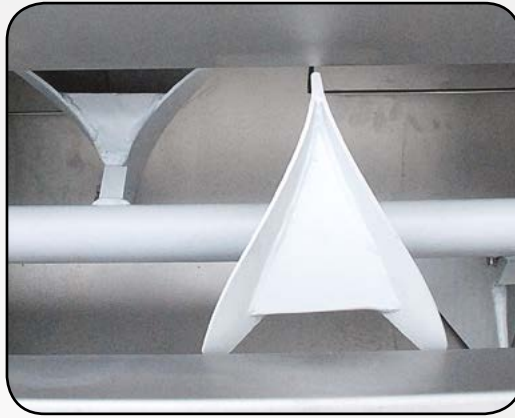

*HB400 wear-resistant steel  
ploughs*

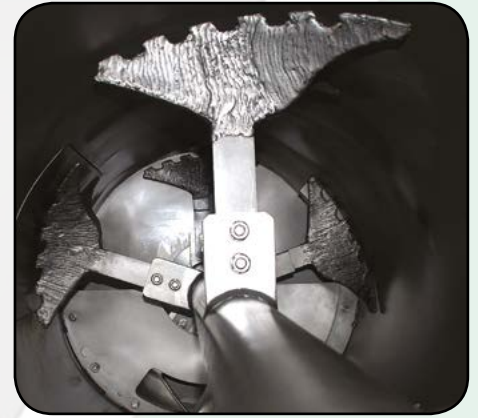

*bolted, toothed ploughs with  
Wolfram Carbide coating*

## Industries



*food & animal feed*



*building & construction*



*chemical & pharma*



*biogas & agro-waste*

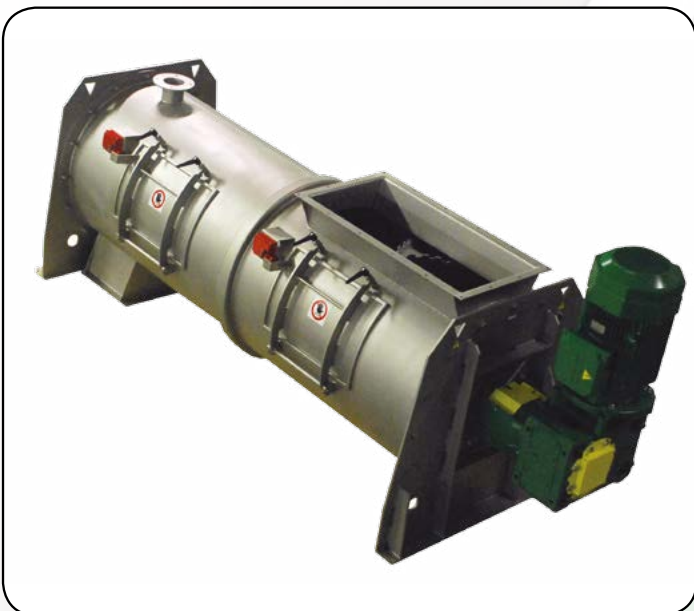

*KC mixer in SS304*



*KC mixer for agricultural waste*

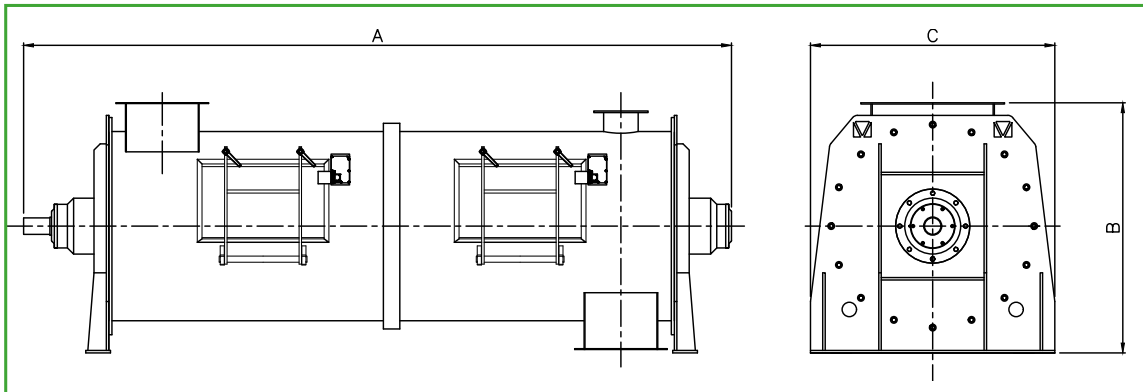

Mixer Model	Min. Capacity (m <sup>3</sup> /h) *	Max. Capacity (m <sup>3</sup> /h) *	A (mm)	C (mm)	B (mm)	Installed Power (kW)
KC 90	1,6	2,7	1500	510	500	0.7 ÷ 3.0
KC 170	3,1	5,2	1810	610	605	1.1 ÷ 7.5
KC 300	5,3	8,8	1960	720	710	2.2 ÷ 11
KC 600	8,1	13,6	2550	860	850	5.5 ÷ 18.5
KC 1200	17,3	28,8	3060	1020	1015	11.0 ÷ 30.0
KC 2000	23,0	38,4	3400	1200	1195	18.5 ÷ 45.0
KC 2500	40,6	67,6	3650	1310	1300	22.0 ÷ 55.0
KC 4400	71,4	119,0	4500	1530	1520	22.0 ÷ 75.0
KC 6500	94,6	157,7	5000	1800	1780	30.0 ÷ 75.0
KC 9000	150,6	250,9	5850	1910	1900	37.0 ÷ 90.0
KC 11000	188,2	313,7	5850	2090	2050	45.0 ÷ 110.0

\* capacity is calculated considering a retention time of 60 seconds and a 50% filling load



**MC<sup>2</sup> Srl**  
 via S. Domenico, 7  
 40124 Bologna (BO) Italy  
 T. +39 059 8723725

E. [info@mc2-srl.com](mailto:info@mc2-srl.com)  
 W. [www.mc2-srl.com](http://www.mc2-srl.com)

